



**MDI**  
GURGAON

Management  
Development  
Institute

MDI/Estate/Renovation/Board Room/2022

04<sup>th</sup> October 2022

**Sub: Renovation works of Board Room in Scholars Building at MDI Campus.**

**1. Time schedule for tender process:**

Sr. No	Description Details	Date and Time
1	Date of publication of tender notification	04/10/2022
2	EMD	25,000/-
3	Last date for receipt of duly filled in tenders	27/10/2022

**2. INTRODUCTION**

Management Development Institute Gurgaon, (MDIG), Haryana (hereinafter referred to as the "Institute") is one of the Institute of national reputed on which is dedicated to offer world class programmes in Management Education. The Institute Invites Sealed Tenders on 'Single Bid System' as mentioned hereunder in the attached prescribed format from reputed Agency/Firm having adequate experience in similar type of work (Renovation works).

**3. TENDER NOTICE:**

MDI invites sealed Tenders under Single bid systems for Renovation works of Board Room in Scholars Building at MDI Campus, from the firms/ companies who have carried out the same nature of works.

The prospective Bidders are advised to read the entire tender document carefully and satisfy themselves about the work, site condition by visiting the MDI Campus (Estate office), on any working day between 10.00 a.m. and 5.00 p.m. before submitting their tenders (nothing is payable for visiting the MDI campus in this regard). The sealed tender as Specified in the tender document may be address it to

**"The C E (Estate),  
Management Development Institute,  
Mehrauli Road Sukhrali, Gurgaon, HR-122007"**

so as to reach on or before 03.00 PM, 27.10.2022, at Estate department at Takshashila building before last date and time.

**4. Submit the following documents:** The agencies/companies shall enclose the copies of the following documents

- (i) Latest Income Tax Clearance Certificate.
- (ii) The agencies/companies have valid GST & PAN registration (Copy attached).
- (iii) ESI, PF registration Certificate.
- (iv) The proof of work experience from the client be attached along with the tender.

**5. Mode of Submission:**

The price bid & EMD should be sealed in separate covers duly super scribed as 'Price Bid' & 'EMD' in the appropriate covers & both these sealed covers are to be put in a bigger cover which should also be sealed & duly super scribed and mention in top of cover **"Renovation works of Board Room in Scholars Building at MDI Campus"**. Any Addendum/Corrigendum date extension in respect of above

tender shall be updated in our website only and no separate notification shall be issued in the press/Bidders.

6. **Earnest Money Deposit (EMD):**

1. The Earnest Money Deposit (EMD) of an amount of Rs. 25,000/- in the form of Demand Draft only in favor of **Management Development Institute** and payable at **Gurgaon**, EMD will not bear any interest.
2. **Forfeiture of the EMD:** If any tenderer withdraws the rates, the EMD amount deposited by him will be forfeited and he will be disqualified from participating in any future tender of the Institute.
3. Refund of EMD: The EMD of unsuccessful tenderer will be refunded within 45 working days of opening of price bid.
4. If the EMD is not enclosed, the Tender offer will be summarily rejected
5. **Cheque will not be accepted towards EMD.**
6. The Earnest Money Deposit/Security Deposit will be forfeited and they will be disqualified from participating in any future tender of the Institute if:
  - a) Tenderer withdraws his tender or backs out after acceptance.
  - b) Tenderer fails to remit the EMD.
  - c) Tenderer violates any of the conditions prescribed in the Tender Document.
  - d) Tenderer revises any of the terms quoted, during validity period
  - e) If the successful tenderer fails to enter into an agreement. In the event of refusal to carry out work by the successful Bidder on any grounds.

7. **Performance guarantee (PG):**

1. The EMD amount of Rs. 25,000/-of successful bidder will be retained as security deposit in the form of performance guarantee for the period of 180 days of satisfactory completion of works. No interest shall be accrued on the deposit before the agreement with MDI, Gurgaon is entered in to.
2. **Forfeiture of the EMD:** The whole amount of the earnest Money deposit shall be liable to be forfeited in case of breach of any of the terms agreed upon by the contractor. The whole amount of the EMD shall be liable for forfeiture in event of the contractor not being able to continue the contract for the entire duration of the contract on the same rates, terms and conditions.

8. **Eligibility Criteria:**

1. The agency should have executed at least two similar types of works.
2. The value of single order is not less than fifty lakhs.
3. The agency should have been in work experience since last 5 years.
4. The proof of work experience attached with the tender.

9. **AWARD OF WORK**

The agency quoting the lowest rate for above tender shall be considered for award of work. However, MDI does not bind itself to accept the lowest or any other offer and reserves the right to accept or reject any or all the offers either in full or part without assigning any reason or bargain to arrive reasonable rates.

10. **Terms and conditions are as under**

- (i) The price quoted for the above items should be inclusive of packing, transportation, insurance, loading & unloading, installation, and exclusive of GST. The price should be quoted in price format (Annexure-I) only.





- (ii) The scope of work shall include Renovation works of Board Room in Scholars Building at MDI Campus. This will also include delivery & installation at site. The successful bidder will assume full responsibility of the complete system until final acceptance.
- (iii) Payment will be restricted to actual quantity supplied/executed at site.
- (iv) The entire work should be completed within 30 days of the confirmed order in writing by the Institute.
- (v) In case the work is not completed within the date stipulated penalty shall be imposed Rs. 5000/- each day of delay subject to a maximum of Rs.1,00,000/- (Rs One Lakh only). However, Director, MDI shall be empowered to grant extension of time on valid grounds.
- (vi) In case any item is found to be defective /substandard, the same shall be rejected and no amount shall be paid for such items and such items shall be removed from the site immediately on cost to the suppliers has to be replaced.
- (vii) The work shall be executed as per CPWD specification. The mode of measurements of work done shall also be based on CPWD specification.
- (viii) The contractor shall take all safety precautions for the safety of his employees and the Institute shall not be, in any way, liable for any damage/ liability on account of any mishap or negligence of the contractor.
- (ix) You shall be responsible for any mishap/accident and liability, if any, falling thereof, shall be entirely yours and the Institute shall in no way be responsible for the same.
- (x) Water and electricity shall be supplied by the Institute free of cost.
- (xi) Contractor shall bring only the actual quantity of materials required after measuring the actual area of work to be done at site.
- (xii) The dismantled mulba/rubbish should be disposed off outside the campus at a suitable dumping ground at no extra cost within 3 days of completion of work or it would be got done by the Institute at the risk and cost of the contractor and the said amount shall be deducted from the bills of the Contractor.
- (xiii) The watch and ward of materials brought at site shall be the responsibility of the contractor.
- (xiv) The contractor must get acquainted with the proposed site for the work and study specifications and conditions before quoting the rates.
- (xv) The contractor shall get the samples of materials approved sufficiently in advance from the Institute. The materials brought at site shall strictly conform to the quality of samples approved and in case of variation such materials shall liable to be rejected and to be removed from the site within 24 hours of the rejection by the Engineer-in- Charge/Officer.



**(xvi) Terms of payment: -**

- (a) 80% on delivery of approved items in the campus, within 30 days of submission of correct invoice for the items supplied and certified to be in good and acceptable condition by the estate deptt. Proof of payment of GST challan has to be submitted by the suppliers.
- (b) 10% of supply value shall be paid on completion of installation /laying/placing of the supply furniture as per the requirement of the purchaser within 15 days of completion of such activity.
- (c) Balance 10% of supply value shall be paid within 30 days of satisfactory completion of all contractual obligations of specified for supply installation/placing/laying of all furniture item as mentioned in the BOQ.

**11. Technical Specifications**

- a) **A sample of every item of furniture shall be submitted for approval before bulk manufacturing.** Approved samples shall be used as standard of finish and workmanship.
- b) Good quality teak wood timber shall only be used for the furniture to be supplied. It shall be best of its kind as set out in section - carpentry and joinery well seasoned and kiln dried with a moisture content of 12 A nominal A + 2% for teak wood. It shall be matched for colour and grain free from work holes, loose or dead knots or other defects and sawn die square.
- c) Plywood/block shall be of premium quality, resin bonded CWR brand, weather proof, close grained plywood suitable for veneering, painting or bonding plastic laminate as require. Exposed edges of plywood block boards shall be finished with a strip of solid wood, tongued and grooved and glued. The ply board shall be of brand name DURIAN/ DURO/GREEN/CENTURY/WOOD TOUCH. LAMINATION SHALL BE MARINO/FORMICA/ DECOLUM/ GREENLAM BRAND of 1.00 mm thickness and Pre laminated board brand name Greenlam /Marino etc.
- d) Grain directions of wood grain laminated sheeting shall be as follows. Length wise on horizontal surfaces. Vertical on vertical surface. Horizontal on edges top surfaces and shelves.
- e) All joints shall be standard mortise and tenon, dowel, overall cross halved, mitered tongue and grooved and rebated. Nailed butt joints will not be permitted. ISI approved adhesives shall be used for the carpentry and joinery work.
- f) Timber veneers shall be finished by the application of two coats of an acid catalyzed clear melamine. The finish shall be a satin, semi gloss finish. The lacquer shall be applied evenly by spraying to give an even coat to the veneer surface.
- g) Cushion vents shall be provided at the back or underside of all seat cushions in sufficient number to allow air to escape easily and prevent from scams.
- h) Stained spirit polish with melamine finish for wood work shall be carried out wherever polishing is specified.
- i) MDI shall have the right to expose the furniture for inspection purpose. Supplier has to repair the same at his own cost.





- j) Vinyl flooring 3 mm thick manufactured by one of the agency like M/s, LG, Armstrong, Premier shall only be used. The sample of the tiles shall be got approved before commencement of work. Good quality of adhesive shall be used for fixing the tiles. Nothing extra shall be payable for removing the furniture from the rooms for fixing flooring and placing it back after completion of work.
- k) First quality paint manufactured by the following firms (in the same order of preference) shall be used and only be brought to the site in sealed containers. Contractor should also ensure that only the required quantities of materials should be brought to the Campus.
- i. Paint & Primer - Nerolac /Johnson & Nicholson/British Paint/ Asian Paints/Berger
  - ii. Snow cem - Super snowcen / Indocem/ Acrocem
  - iii. Distempering - Berger / Shalimar / Asian
- l) The splashes of white wash, painting and distemper shall be cleaned by the Contractor at his own cost and no extra payment will be admissible for the same.
- m) Supplier shall make all arrangements for inspection at their workshop as and when asked by MDI.
- n) All hardware fittings, knob, ball catcher brass should be Haffle/Godrej/door set.
12. The quantities indicated in the schedule of quantities are approximate only. The quantities can be increased or decreased or totally deleted while placing order by the Institute. Payment shall be made to the actual quantity of furniture supplied or work executed at site.
13. The rates shall be valid for entire duration of work.
14. Before quoting the rate, the supplier may ascertain the requirement(s) and design of furniture (sample available in the Institute) for the purpose supplier may visit the MDI Campus.
15. The Institute reserves the right to get the whole or part of work done through one or more parties
- MDI reserves the right to accept or reject any or all the quotations without assigning any reason whatsoever.

Thanking you,

Yours faithfully,

(D S Rawat)  
C.E Estate

Enclose: Annexure-I & II



## Renovation Works of Board Room (Scholars Building)

S.No	Items Description	Unit	Qty	Rate	Amount
1	Dismantling Existing Carpet tile work i.e. demolishing / chipping of existing Carpet tiles from floors manually or by mechanical means including stacking material within 10-50 Mtrs lead for thickness of tiles 10mm to 25mm and removal of unserviceable material at site as per direction	Sqm	60		
2	Dismantling of Existing False ceiling manually or by mechanical means including stacking material within 10-50 Mtrs lead for thickness of tiles 10mm to 25mm and removal of unserviceable material at site as per direction	Sqm	30		
3	Providing p.o.p on walls of requisite thickness ( minimum 6 Mm )wherever plastic emulsion paint has to be done to make wall smooth, in parts wherever conduiting is done to match with existing pop and surface and line . The measurement would be done in 6",9",1'-0" widths running length and paid in sq.m. ) .	Sqm	25		
4	Providing and finishing with white cement based wall care punning in white cement on wall, partitions / ceiling for making the surface smooth in approximately average 3-4 mm thick layer. All complete as per drawing and specifications and direction of the Engineer-in-Charge. Make- JK & Birla	Sqm	40		
5	Providing and applying Two coats of pre-approved Plastic acrylic emulsion paint to walls, partitions etc. including surface preparation( including removal /scrapping of old paint if any)Ofrom the wall with two coats of putty, primer and sanding all complete. With the necessary drying periods for each coat. The final finish should be of a uniform and neat finish to the satisfaction of the Architect. Cost to be include for all height and surfaces.(Low VOC contain paint) Make: ICI DULUX .Asian Paints	Sqm	40		
6	Providing and fixing in position Laminate / teak veneer ply paneling with appropriate and necessary dash fasteners to ensure stability. The paneling with using 2" X 2" (finished) fine dried 1st class champ wood for internal frame at 2'-0" X 2'-0" c/c distance (max) in both directions horizontally & vertically with steel fittings, and also consists of 12mm commercial ply with 4mm th. teak MDF for grooving, all teak finish laminate / teak veneer to be finished in desired colour and all frame with one coat of primer and one coat of synthetic enamel paint complete in all respects as per detailed drawings and as directed by the concerned official.	Sqm	65		
7	Providing & Fixing Gypsum board false ceiling, as per the design & drawing, with 12.5mm gypsum board screwed on G. I. Frame work. The framework made up of Gyp. steel with perimeter channels 20 X 27 X 30 X 3657 mm fixed on wall & partitions and ceiling sections 80 X 26 X 0.5 X 3657 mm as a cross member provided 457mm c/c & the intermediate channel of 15 X 45 X 0.09 X 3657 mm as main of G. I. angle 25X25X0.5mm from the existing R. C. C. ceiling by means of M. S. raw plug with bolts/ screws at 1200mm c/c max. The joints of gypsum board to be taped 3 times and sealed with jointing compound. . Rates includes all design works (coves, domes, steps, curves, etc.). Double measurement shall not be done for any design works (coves, domes, steps, curves, etc.). False ceiling to be painted with 1 coat primer and min. 3 coats of Plastic Emulsion paint of approved make, colour, shade. Rates including cost of scaffolding, framework, suspenders etc. Complete in all respects as per Engineer/Architect incharge	Sqm	25		
8	Providing and fixing Armstrong ceiling (Black T- Junction) of mineral fiber based 600 X 600 X 15 mm modular false ceiling, 15 mm thick ANF micro look with sill houte 38 (6mm black reveal) grid (Frame work for sill houte grid as per Company's standard specification). False ceiling of approved quality over M/S Armstrong world industries (India ) Ltd trulock suspension systems of required weight as per architects app at required spacing, finishing of all joints neatly to proper line & level including providing of additional framework for electrical fixtures. including giving trap doors where ever required. Cut out are provided to accommodate luminaries, air conditioning grills, Ducting machine, suction & diffusers, trap doors, fire and smoke warning detectors, fire sprinklers, etc. as per the specifications approved by architects Rates including cost of scaffolding, framework, suspenders etc. Complete in all respects as per Bank/ Architect directions. (Make: Armstrong)	Sqm	40		
9	Electricals: Providing electrical work comprising of PVC Conducing, Point / Power wiring, including CAT-6 cabling of D-Link Make, EPBAX, CCTV, LAN & Networking and for Office Automation, HUB common connector, cabling from Router to workstations and cabins an (Havells FRLS or equivalent), Modular Switches, Sockets with boxes (Northwest or Norises or Legrand or equivalent) & respective cover plate. All the wiring shall be terminated at server room / DVR/ Panel room etc as per the design and detail. (All other fittings & fixtures in concerned officials" scope) as per given specifications and amended upto date. <b>Note all electrical/electronics items with remote control operation with latest technology.</b>	Sqm	60		





S.No	Items Description	Unit	Qty	Rate	Amount
10	SITC of 15 watt LED type Down Lighter fitting direct in the fall ceiling (Recessed) type i/c testing commissioning and connection etc complete as required Phillips/wipro/Max or equivalent make) up to 150mm in size whether round or square as per design	Each	20		
11	Providing & fixing Designer profile lights completely customized to the size and designs provided by the Project Architect in required colour & specifications and including the cost of light fixture, cost of customization, fixing materials, labour, transport and lifting & handling charges (30Watt/50mm/6500K/ recessed) 50 mm wide in Designer shape for office / Work station	mtr	20		
12	Supplying, installation, testing and commissioning of necessary MCB's B/ C series & minimum 10kA breaking capacity, RCCB's, isolator etc. in existing distribution boards including dressing, ferruling, thumbing of wires etc. complete as per specifications and details as follows:	Nos	8		
13	Specifications for use of official's/meeting purposes revolving chair: The Seat and Back Cushion of the chairs should be pressed on 12mm hot press moulded ply. The seat cushion of the chair should be made up of 50mm thick High Density of 45±2 Kg/m <sup>3</sup> polyurethane mould and back cushion should be made up of 38mm thick High Density 33±2 Kg/m <sup>3</sup> . The polyurethane foam shall be as per manufacturer's specification. The hardness of foam shall be 20 kg on hampden machine and 25% compression and it should be covered with fabric as per manufacturer's shade card. The arms of the chairs should be black. The Gas lift mechanism should be tested as per BIFMA X 05.01.2002 Standards. The pedestal should be five legged injection moulded in black 30% glass-filled nylon and fitted with 5 nos twin wheel castors. The castors of the chairs should be glass filled, twin wheel castors confirming to BIFMA Standards X 05.01.2002 tested to perform 1,00,000 cycles with 225 lbs Load. It should have synchro single point locking arrangement. Note -. The back and base of the chair should be supplied with fabric upholstered. (Fabric colour shall be approved by concern official ) All material should be used of relevant ISI specification Overall Height of chair should be minimum 970 mm ( Inclusive of maximum adjustment of gas lift mechanism ) All material should be of high quality used of relevant ISI specification and as approved by the concerned officer. Make-Godrej/feather lite & equivalent after approval of Deptt.	Nos	20		
14	Conference Table: Making and fixing of conference table Size = 45'-0" (L) X 2'-0" (W) X 2'-6" (H) made up of 19mm commercial board, 6mm/12mm commercial ply, all exposed/ elevation area to be finished with 4.0 mm MDF for grooves and 1mm Laminate of Merino or equivalent finish in two or more shades and all inside surfaces to be finish with enamel paint and polish after preparing the base smooth by using putty and sand papers as required, teak wood beading & frame as required with all necessary hardware, The cost including fixing of S.S. finish MDI's approved 12" dia 4 nos logo. There must be arrangement of wire manager and electrical POP up boxes with switches and sockets. The exposed edges of the top shall be rounded on both the edges with 3" TW/rubber wood moulding as per design. The skirting shall be 100mm high. All exposed teak wood beading, frame, etc. will be polished. Work should be complete in all respect as per drawing. Complete in all respect as per drawings and direction of Deptt.	Nos	1		
15	Providing and fixing of nylon base carpet floor tiles of size 500x500 of flooring of approved shade /colour. Make : Flotex , Tuntex,Milkin, wondrfloor etc as per approved by Dept.	Sqm	60		
16	Providing fixing and commissioning of new 3-5 star rating ceiling hung cassette airconditioners of 2.0 tonn capacity of approved model and make including frame work in MS section of 6mm for hanging of machines as per approved by Dept..	Nos	2		
17	Removing the existing outdoor units of existing split air- conditioners installed outside the building and then re- installing the same after completion of other interior works gets completed.	Nos	2		
18	<b>ROLLER BLINDS:-</b> Supply & fixing of Roller blinds of approved shade with channels & other fittings & accessories. Complete in all respect as per Bank/ Architect's. (Make: Vista/MAC or equivalent ) <b>with remote control system operation.</b>	Sqm	18		
19	Providing and fixing wooden moulded beading of door and window frames with iron screws plugs and polishing the same matching with the shade and color of the shutter all complete.	Rmtr	14		
20	Providing and fixing of existing flush door finished in 4mm teak veneer over both faces flush door shutters with wooden edge lipping in 2nd class teak wood .....etc compltd.	Nos	2		
21	Providing & Fixing of Door Closers of approved design and make Dorma, Ozone	Nos	2		
22	Providing & fixing of H Door handles of height 600mm with diameter thickness of 25mm made of 304 SS steel grade SS finish including all accessories and hardware Make: Dorma Ozone	Set	2		
23	Providing & Fixing of Door Lock of Dorma/Ozone make with SS steel plate cover having atleast three keys of lock in approved design and shape including all necessary required fittings & accessories	Nos	2		





S.No	Items Description	Unit	Qty	Rate	Amount
24	Supply of Ceiling mount speakers of 10 watt built in line with the matching transformer. Make Bosch	Nos	6		
25	Providing & pasting textured / standard designer wall paper of 0.5mm thickness on existing walls including adhesive etc complete as per approved design by concerned officer.	Sqm	20		
26	Providing and fixing file / storage cabinets in pantry sizes as per design or site requirements made up of BWP block board (of different thicknesses as/ design) finished in machine pressed laminate (colour / texture as per given specification / matching to the adjoining work stations / wood work. A variation of up to 50mm in either dimension shall be tolerable for getting the desired product in mentioned makes. The inside to be finished in 1mm thick laminate or matching to the exteriors. A- class teak wood 4mm lipping / 2mm thick taping shall be used as lipping etc. wherever required, to be polished to match same shade as laminate. Cabinets to be made as per drawing provided , with all necessary fittings and fixtures such as telescopic channels, hinges, magnetic catchers (hettich make) and handles (S.S. brushed finish) , proper locking mechanism, pad lock with steel/ nickel finish, of godrej/doorset / harison or equivalent make etc. all complete. The cabinet shall be mounted either on floor or wall using 6 - 12mm waterproof ply (duro or equivalent ) as backing with wooden anchors (gitti) placed @ 300mm c/c on wall. The item shall include making good any holes, wire managers, + fixing on wall wherever required.				
27	Having depth of up to 230mm	Sqm	10		
28	Having depth of up to 450mm	Sqm	10		
29	P & F Ceiling Fan (600/900/1200 mm sweep) with remote control operation in position effecting proper connection, testing & commissioning of capacitor start complete with all accessories as required. Cost including providing Iron hooks (for hanging CF), vertical rods, making holes, making walls, floor & ceiling fine and finish with masonry, plaster, putty, paini, etc. as required. Including making good, proper finish of walls, floor and roof with masonry, R.C.C., plaster, pop, puty, primer, paint, etc. complete in all respects. Complete fine finish incl. making necessary connection & start of equipment as per Bank/ Architect. (Make:- CG/ BAJAJ/ HAVELS)	Rate Only	4		
30	<b>Aluminium Glass Windows :</b> Supply and Fixing of Slim Glass partition of 10/12mm Toughened Glass using Alexa System-45 Frames to a height of maximum 3m or as per drawing.The Fixed glass to be fixed using Alexa BP45 Profiles at Top & Bottom & Alexa SP45 at sides. The profile size to be 45x25MM to be fixed on to the floor/wall/ ceiling as per the architect design. H Junction profile to be used at all Glass to Glass vertical joints, 90 Deg L Junction Profiles and T Junction profiles necessary as per design.In case of Glass overall panel Alexa MP45 & BP45 Overpanel Profile to be used.In case of Open glass edges EP45 End Profile to be used. The profiles shall be suitable for Glass thickness of 10/12/13.52mm.The Profile shall be matt natural anodized, the Profile Manufacturer to supply all the necessary clips, seals and fixing accessories for the system. All Profiles to be with 2 mm Gauge thickness Excluding 20 Micron of Anodizing. All complete as per drawing and specifications and direction of the Engineer-in-Charge. Work shall be carried out as per approved sample.	Sqm	20		
31	<b>98" Display Commercial Smart TV with 5 year warranty (LG/Samsung/Sony) :</b>  Type Direct LED BLU, Resolution 3840*2160 (4K UHD), Operating System Tizen 4.0 (VDLinux), Pixel Pitch(mm) 0.562 x 0.562 (mm), Active Display Area(mm) 2158.848(H) x 1214.352(V), Brightness(Typ.) 350 nit, Contrast Ratio 1200:1, Viewing Angle(H/V) 178/178, Response Time(G-to-G) 8ms(Typ.), Display Colors 16.7M(True Display)1.07B(Ditherd 10bit), Color Gamut 72%, Operation Hour 24/7, Haze 25%, Dynamic C/R Mega H-Scanning Frequency 30 ~ 81kHz, V-Scanning Frequency 48 ~ 75HZ, Maximum Pixel Frequency 594MHz,Speaker Type Built in Speaker(10W + 10W), Input RGB DVI-D, Display Port 1.2 (1), Video HDMI 2.0 (2), HDCP HDCP2.2 Audio Stereo mini Jack, DVI, HDMI USB USB 2.0 x 2,Output RGB HDMI 2.0 (Loop-out) Audio Stereo mini Jack External Control RS232C(in/out) thru stereo jack, RJ45, External Sensor IR,Bezel Width (mm) 17.9, Key Features UHD Signage Display Slim & Light Signage with Built-in MagicInfo S6, SSSP 6.0, Orientation N/A, Remote Control N/A, Special Features: H/W : Temperature Sensor,Pivot Display, Clock Battery(168hrs Clock Keeping), Built in Speaker(10W 2ch), Video Wall Daisy Chain(HDCP2.2:4EA,HDCP1.4:7EA), Wi-Fi/BT S/W : Auto Source Switching & Recovery, LFD Home UI, Button Lock, Hot key option, Plug&Play (Initial Setting), 802.1x(WPA2 Enterprise) Certified, Processor Cortex A72 1.7GHz Quad-Core CPU, On-Chip Cache Memory L1 Instruction Cache : 48KB L1 Data Cache : 32KB L2 Cache : 2MB, IO Ports USB 2.0	Nos	1		
	<b>Grand Total</b>				
	<b>GST</b>				
	<b>Grand Total</b>				





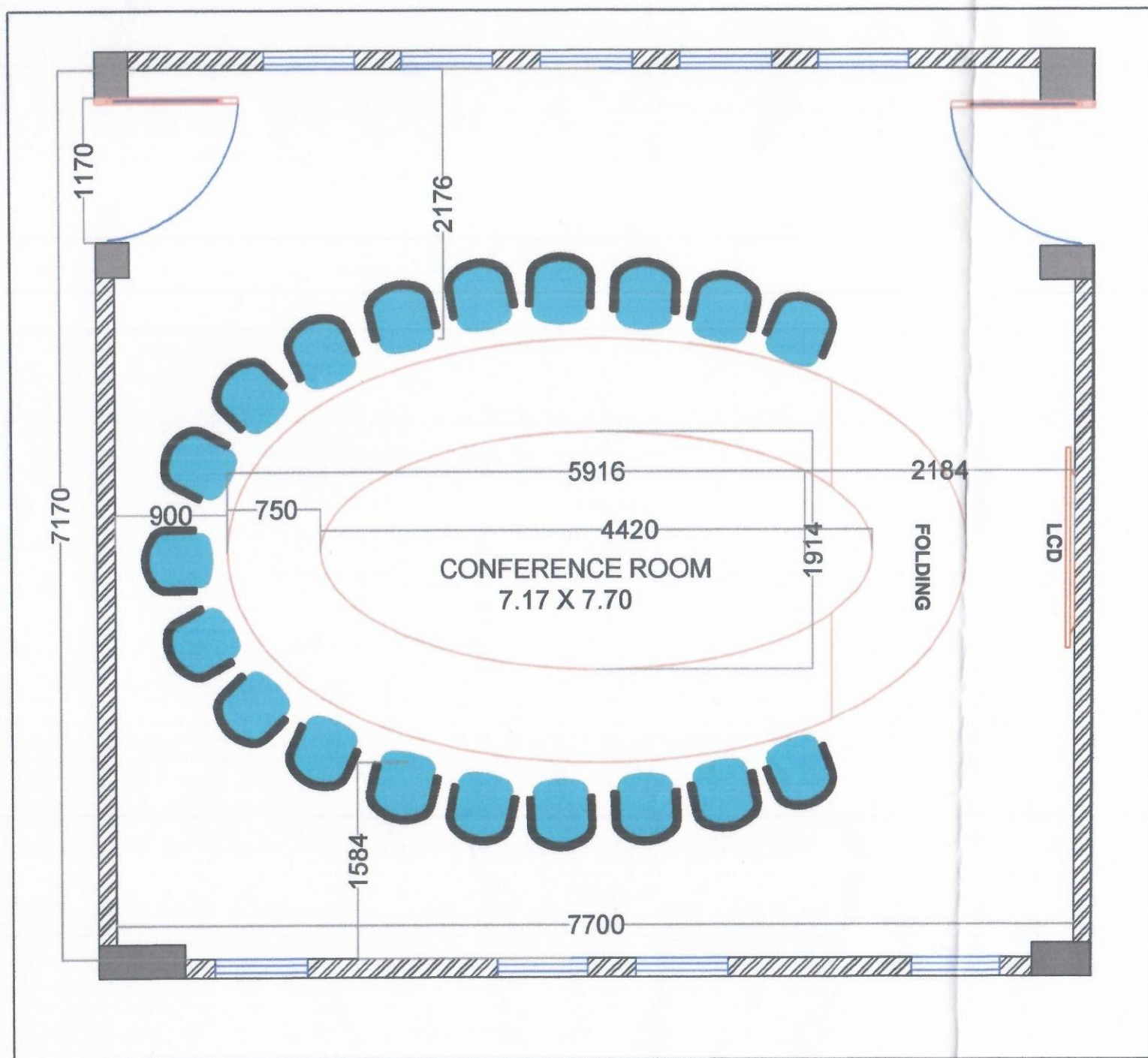

23.52

25.26





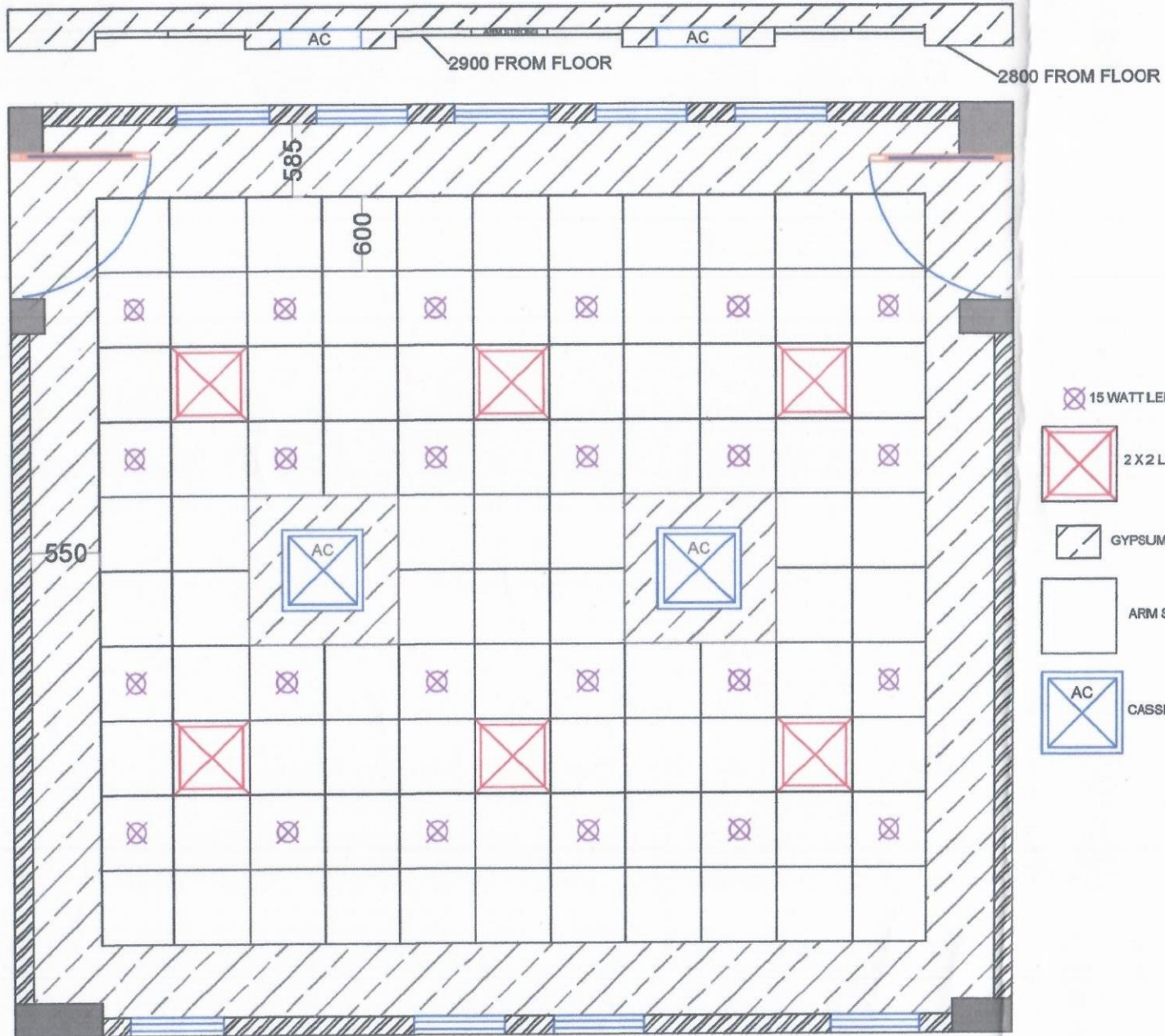

⊗ 15 WATT LED

⊗ 2 X 2 LED PANEL

▨ GYPSUM CEILING

□ ARM STRONG

⊗ AC CASSETTE AC